

COLUMNS LAYOUT PLAN

SCALE 1:100

SCHEDULE OF COLUMNS						
COLUMN MARKED	NOS. OF COLUMNS	COLUMN SIZE (mm x mm)	FOUNDATION TO 2nd FLOOR	2nd FLOOR TO 5th FLOOR	5th FLOOR TO ROOF AND ABOVE ROOF	
			LONGITUDINAL	LONGITUDINAL	LONGITUDINAL	
C1, C13, C21, C23, C27, C30	06	300X500	REINFORCEMENT: 12-25 ϕ	REINFORCEMENT: 8-25 ϕ +4-20 ϕ	REINFORCEMENT: 4-25 ϕ +8-20 ϕ	TIE NEAR JUNCTION (UPTO 'lc') LENGTH LINKS: 8 ϕ 75 C/C (4 NOS. CLOSED LINK PER SET) AT REST PORTION LINKS: 8 ϕ 150 C/C (4 NOS. CLOSED LINK PER SET)
C20, C25	02	300X550	REINFORCEMENT: 12-25 ϕ	REINFORCEMENT: 8-25 ϕ +4-20 ϕ	REINFORCEMENT: 4-25 ϕ +8-20 ϕ	TIE NEAR JUNCTION (UPTO 'lc') LENGTH LINKS: 8 ϕ 75 C/C (4 NOS. CLOSED LINK PER SET) AT REST PORTION LINKS: 8 ϕ 150 C/C (4 NOS. CLOSED LINK PER SET)
C2, C6, C7, C10, C17	05	300X500	REINFORCEMENT: 12-25 ϕ	REINFORCEMENT: 6-25 ϕ +8-16 ϕ	REINFORCEMENT: 6-25 ϕ +8-16 ϕ	TIE NEAR JUNCTION (UPTO 'lc') LENGTH LINKS: 8 ϕ 75 C/C (4 NOS. CLOSED LINK PER SET) AT REST PORTION LINKS: 8 ϕ 150 C/C (4 NOS. CLOSED LINK PER SET)
C3, C4, C12, C15, C18, C19, C26, C29, C31, C32, C33	11	300X500	REINFORCEMENT: 6-25 ϕ +8-20 ϕ	REINFORCEMENT: 4-25 ϕ +8-20 ϕ	REINFORCEMENT: 4-25 ϕ +8-20 ϕ	TIE NEAR JUNCTION (UPTO 'lc') LENGTH LINKS: 8 ϕ 75 C/C (4 NOS. CLOSED LINK PER SET) AT REST PORTION LINKS: 8 ϕ 150 C/C (4 NOS. CLOSED LINK PER SET)
C5, C8, C22, C28	04	300X550	REINFORCEMENT: 6-25 ϕ +8-20 ϕ	REINFORCEMENT: 4-25 ϕ +8-20 ϕ	REINFORCEMENT: 4-25 ϕ +8-20 ϕ	TIE NEAR JUNCTION (UPTO 'lc') LENGTH LINKS: 8 ϕ 75 C/C (4 NOS. CLOSED LINK PER SET) AT REST PORTION LINKS: 8 ϕ 150 C/C (4 NOS. CLOSED LINK PER SET)
C9, C11, C14, C16	04	300X650	REINFORCEMENT: 6-25 ϕ +8-20 ϕ	REINFORCEMENT: 4-25 ϕ +8-20 ϕ	REINFORCEMENT: 4-25 ϕ +8-20 ϕ	TIE NEAR JUNCTION (UPTO 'lc') LENGTH LINKS: 8 ϕ 75 C/C (4 NOS. CLOSED LINK PER SET) AT REST PORTION LINKS: 8 ϕ 150 C/C (4 NOS. CLOSED LINK PER SET)
C24	01	300X650	REINFORCEMENT: 16-25 ϕ	REINFORCEMENT: 8-25 ϕ +8-20 ϕ	REINFORCEMENT: 6-25 ϕ +10-20 ϕ	TIE NEAR JUNCTION (UPTO 'lc') LENGTH LINKS: 8 ϕ 75 C/C (4 NOS. CLOSED LINK PER SET) AT REST PORTION LINKS: 8 ϕ 150 C/C (4 NOS. CLOSED LINK PER SET)
ST-1	01	250X250	REINFORCEMENT: 4-16 ϕ	REINFORCEMENT: 4-16 ϕ	REINFORCEMENT: 4-16 ϕ	TIE NEAR JUNCTION (UPTO 'lc') LENGTH LINKS: 8 ϕ 150 C/C (1 NO. CLOSED LINK PER SET) AT REST PORTION LINKS: 8 ϕ 150 C/C (1 NO. CLOSED LINK PER SET)

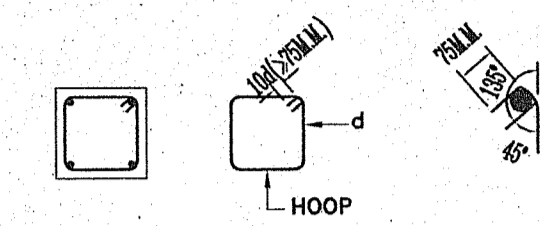

STIRRUP DETAIL
(d = DIA OF STIRRUP BAR)

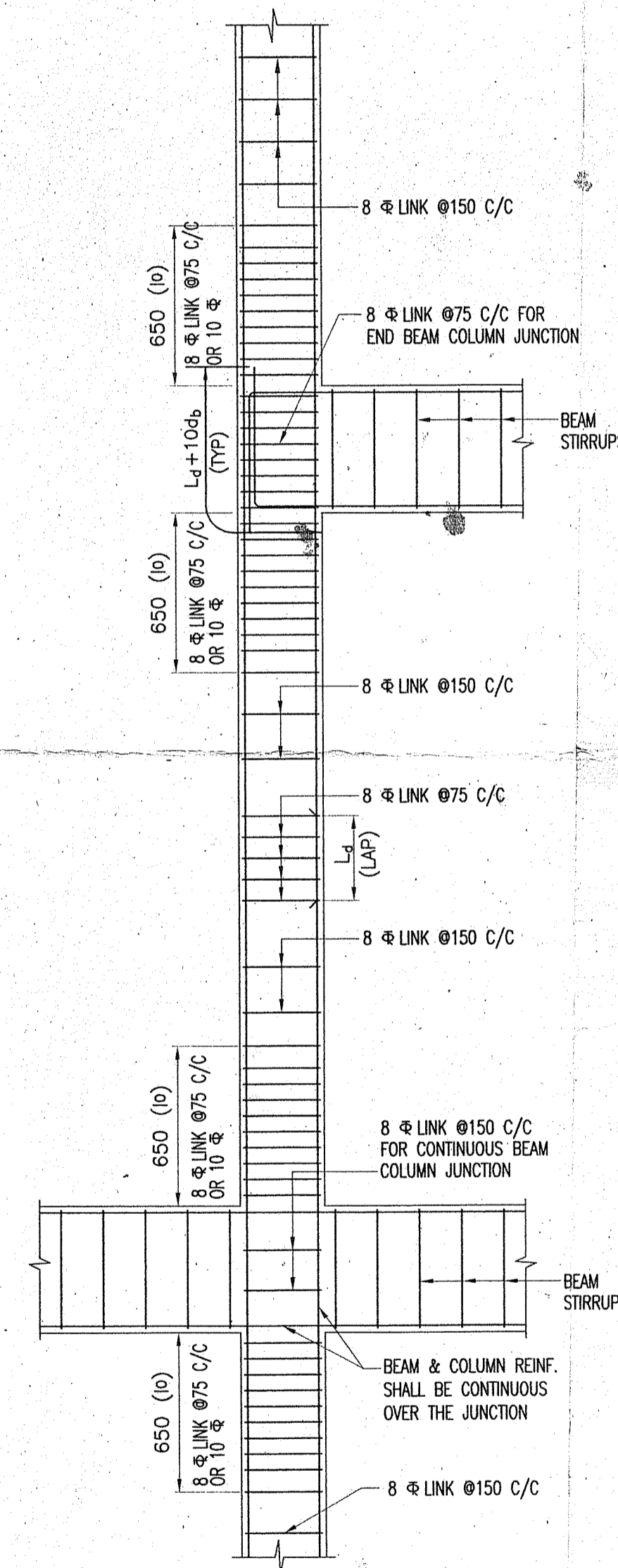

TYPICAL DETAIL OF BEAM COLUMN JUNCTION
SCALE 1:25

CHECKED & VETTED

DR. D. N. K. KARAVAN
Professor, Civil Engineering Department,
Jadavpur University, Kolkata-700032
B.E. (J.U.) - Gold Medalist
M. Tech (IIT KGP) - Gold Medalist,
P.D. (IIT KGP)
R-24848437 * O - 24146943 * M - 9830188502

Approved on Meeting
No. 27/11/2017 Date: 22/11/2017
Valid upto: 21/11/2019

Mallika Laha
Pradhan
Jemua Gram Panchayat

- NOTES:-
- UNLESS OTHERWISE STATED ALL CONSTRUCTION ACTIVITIES SHALL BE CARRIED OUT CONFORMING TO RELEVANT (INDIAN) STANDARD CODES OF PRACTICE.
 - ALL DIMENSIONS ARE IN MILLIMETERS & LEVELS ARE IN METER. EXCEPT OTHERWISE MENTIONED ONLY WRITTEN DIMENSIONS SHALL BE FOLLOWED. ALL LEVELS GIVEN IN STRUCTURAL DRAWINGS ARE IN ACCORDANCE WITH ARCHITECTURAL DRAWINGS. AND INDICATE STRUCTURAL LEVEL ONLY (WITHOUT FINISH). HOWEVER ARCHITECTURAL DRAWING TO BE COORDINATED FOR ALL LEVELS.
 - ALL STRUCTURAL DRAWINGS SHALL BE READ ALONG WITH THIS DRAWING AS WELL AS RELEVANT ARCHITECTURAL DRAWINGS.
 - ANY DISCREPANCY IN THE STRUCTURAL AND ARCHITECTURAL DRAWINGS SHALL BE BROUGHT TO THE NOTICE OF STRUCTURAL CONSULTANT BEFORE EXECUTION OF WORK.
 - UNLESS OTHERWISE SPECIFIED ALL REINFORCEMENT TO BE USED SHALL BE TMT. BARS OF GRADE Fe-500/500 D CONFORMING TO IS-1786-2008.
 - ADEQUATE CHAIR BARS TO BE PROVIDED TO KEEP THE TOP REINFORCEMENT IN PROPER POSITION.
 - UNLESS OTHERWISE STATED LAP LENGTH OF BARS SHALL BE DEVELOPMENT LENGTH=50 ϕ BAR DIA.
 - UNLESS OTHERWISE SPECIFIED DISTRIBUTION REINFORCEMENT SHALL BE 8 T @ 250 C/C
 - CONCRETE COVER TO MAIN REINFORCEMENT SHALL BE AS FOLLOWS:
i) COLUMNS : 40 MM
ii) SLAB : 20 MM
 - GRADE OF CONCRETE FOR COLUMNS SHALL BE AS FOLLOWS :-
FOUNDATION TO 4TH FLOOR - M30
4TH FLOOR TO ROOF - M25
 - DEVELOPMENT LENGTH 50XD FOR LAP & SPICES SHOULD BE PROVIDED AS PER THE PROVISIONS LAID DOWN IN SP34:1987
 - WHREVER A SUPPORTED MEMBER TERMINATES AT A SUPPORTING MEMBER THE BARS OF THE SUPPORTED MEMBER SHOULD HAVE AN ANCHORAGE OF 50D IN THE SUPPORTING MEMBER DRAWING.

TITLE
PROPOSED STRUCTURAL DRAWING OF G+7 (EIGHT STORIED) STORIED APARTMENT BUILDING FOR ABHEENANDAN REAL INFRA VENTURES LLP. OVER R.S. PLOT NO.- 125(P), L.R. PLOT NO. - 379, 388, R.S KHATIAN NO. - 339, L.R. KHATIAN NO. - 2214, MOUZA - SANKARPUR, J.L. NO.- 109, P.S. - NEWTOWNSHIP, DIST.-BURDWAN.

CERTIFICATE OF STRUCTURAL ENGINEER
THE STRUCTURAL DESIGN AND DRAWING OF BOTH FOUNDATION AND SUPERSTRUCTURE OF THE BUILDING HAS BEEN MADE BY ME, CONSIDERING ALL POSSIBLE LOADS INCLUDING THE SEISMIC LOAD AS PER THE NATIONAL BUILDING CODE OF INDIA AND CERTIFIED THAT IT IS SAFE AND STABLE IN ALL RESPECT.

Susmita Choudhury
SUSMITA CHOUDBI
CIVIL ENGINEER (B. T. & C.)
W.B.U.T.
15/8/17

CERTIFICATE OF ARCHITECT/ENGINEER
I DO HEREBY CONFIRM AND CERTIFY WITH FULL RESPONSIBILITY THAT THE BUILDING PLAN HAS BEEN PREPARED BY ME KEEPING THE PROVISION OF NBC OF INDIA AND CERTIFY THAT IT IS SAFE & STABLE IN ALL RESPECT.

Vijaya Singh
VIJAYA SINGH
Consulting Architect
DMC Registered
LIC No.-DMC/BPD/60
Samba Chakraborty
SAMBHA CHAKRABORTY
CONSULTING ARCHITECT
CA/2010/43834

SIGNATURE OF GEOTECHNICAL ENGINEER
THIS IS TO CERTIFY THAT THE SOIL TEST HAS BEEN PERFORMED BY ME FOR THIS PROJECT
ALOK ROY
Empanelled Geotechnical Engineer
Kolkata Municipal Corporation
Class-1, No.- G.7/11
64, Milan Park,
Kolkata-700 064

CERTIFICATE OF OWNER
THIS IS TO CERTIFY THAT I SHALL NOT ON A LATER DATE, MAKE ANY ADDITION OR ALTERATION TO THIS PLAN. THIS IS CERTIFIED THAT I HAVE GONE THROUGH THE NBC OF INDIA AND ALSO ABIDE BY THOSE RULES DURING AND LATER CONSTRUCTION OF BUILDING.
ABHEENANDAN REAL INFRA VENTURES LLP
PARTNER

SIGNATURE OF PANCHAYAT PRADHAN
Approved on Meeting
No. 27/11/2017 Date: 22/11/2017
Valid upto: 21/11/2019
Mallika Laha
Pradhan
Jemua Gram Panchayat

DRAWING TITLE: Jemua Gram Panchayat

SHT. SIZE	SHEET NO.	REV.	R-0	R-1	DWG. NO.
A1	2 OF 4	DATE	10.02.17	15.03.17	SE/ST/ABH/16-17/01